

CATIA PLM Express

CATIA - Structure & Steel Work Layout

Easily defines the layout of a building or a manufacturing plant

Industries require a quick and accurate solution for preliminary design of steel assemblies that integrates the routed systems, such as piping, tubing, HVAC ducts, and cable trays.

Overview

CATIA - Structure and Steel Work Design option is the ideal tool for quickly designing steel assemblies for the tooling, aerospace, shipbuilding and plant design industries.

Customer Benefits

- Rapidly design structures using catalogues of standard or custom sections
- Creation of the preliminary layout of the required systems that will be later used in the detailed design phase
- Optimize the routing for all disciplines in the conceptual design phase
- Define the path and space requirements for routed systems such as piping, tubing, HVAC ducts or cable trays

Key Capabilities

- Design and layout of structures and steel work
- Enable to simply and quickly create linear, curved structures, and plates using standard or user-defined sections
- Include catalogues of resolved Sections: generation of user customizable Bills of Materials
- Integrate knowledge rules to check parts' manufacturability
- Distributed systems layout, i.e. raceway, hvac, piping, tubing, etc.,
- Plant layout, layout of space allocation, space reservation, layout of equipment, etc.,
- Natively integrated with other CATIA applications thereby enabling the completion of the structure's design
- Optimized user interface to easily create and modify structures thanks to the fully associative design in context capability

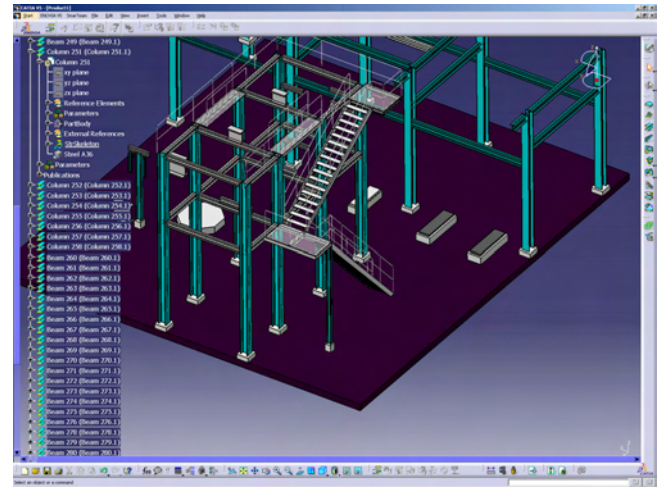

Screen capture of CATIA - Structure & Steel Work Layout

Visit us at www.3ds.com/my-catia-plm-express

About Dassault Systèmes

a world leader in 3D and Product Lifecycle Management (PLM) solutions, Dassault Systèmes brings value to more than 90,000 customers in 80 countries. A pioneer in the 3D software market since 1981, Dassault Systèmes develops and markets PLM application software and services that support industrial processes and provide a 3D vision of the entire lifecycle of products from conception to maintenance. The Dassault Systèmes portfolio consists of CATIA for designing the virtual product - SolidWorks for 3D mechanical design - DELMIA for virtual production - SIMULIA for virtual testing and ENOVIA for global collaborative lifecycle management, including ENOVIA VPLM, ENOVIA MatrixOne and ENOVIA SmarTeam. Dassault Systèmes is listed on the Nasdaq (DASTY) and Euronext Paris (#13065, DSY.PA) stock exchanges. For more information, visit <http://www.3ds.com>

CATIA, DELMIA, ENOVIA, SIMULIA and SolidWorks are registered trademarks of Dassault Systèmes or its subsidiaries in the US and/or other countries. Copyright Dassault Systèmes 2002, 2006. All rights reserved. IGRIP®, QUEST®, IGRIP®, ULTRAARC®, ULTRAPAINT®, ULTRASPOT®, VIRTUAL NC® are registered in the US Patent and Trade Mark Office by DELMIA Corp. INSPECTTM is owned by DELMIA Corp.

